



Principles of Re-establishment

Exercise 8

Natural Boundaries Created in Plans



Questions:

1. Little Steavenson River appears to be a natural watercourse. What part of the feature should be adopted as the title boundary?
2. Does s.385 of the *Land Act 1958* apply?

Answers:

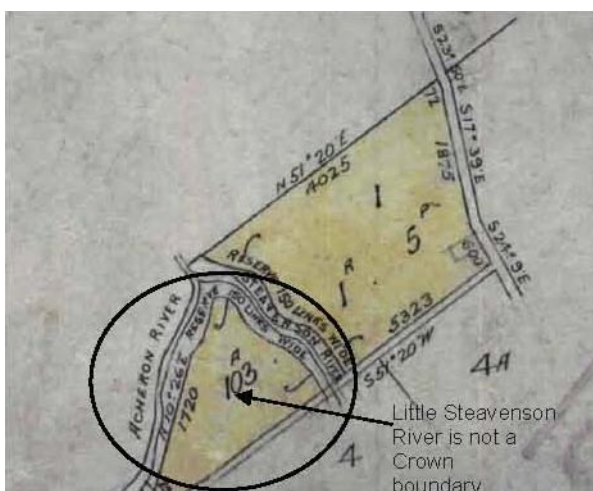

Principles of Re-establishment

Exercise 8

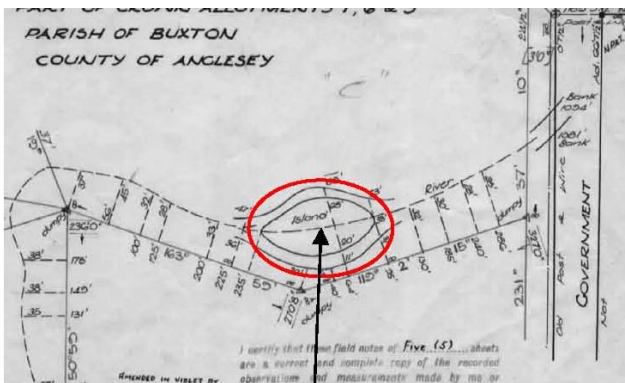
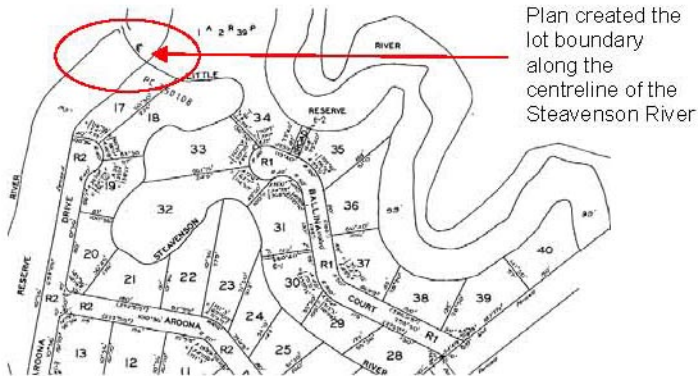

The original survey showed that the lot boundary was not the river around the island.



A re-establishment of lot 29 should maintain the position of Little Steavenson River as located in the parent survey.

LP95203 was consented to by council and subsequently approved by the Register on the 11th November 1972.

A new boundary was created along the centreline of the Little Steavenson River.

The common boundary between lots 29 and 30 terminates on the production of the centreline of the river on the island.

The Little Steavenson River is not a Crown boundary and is not covered by the provisions of s.385 of the Land Act 1958.

Although the Little Steavenson River appears to be a natural boundary, it should be treated as a fixed boundary in the position shown on the plan at the time of survey.

Any alteration in its position would need to be by a formal amendment application.

